

1 21 ST DECEMBER - 9AM
NTS

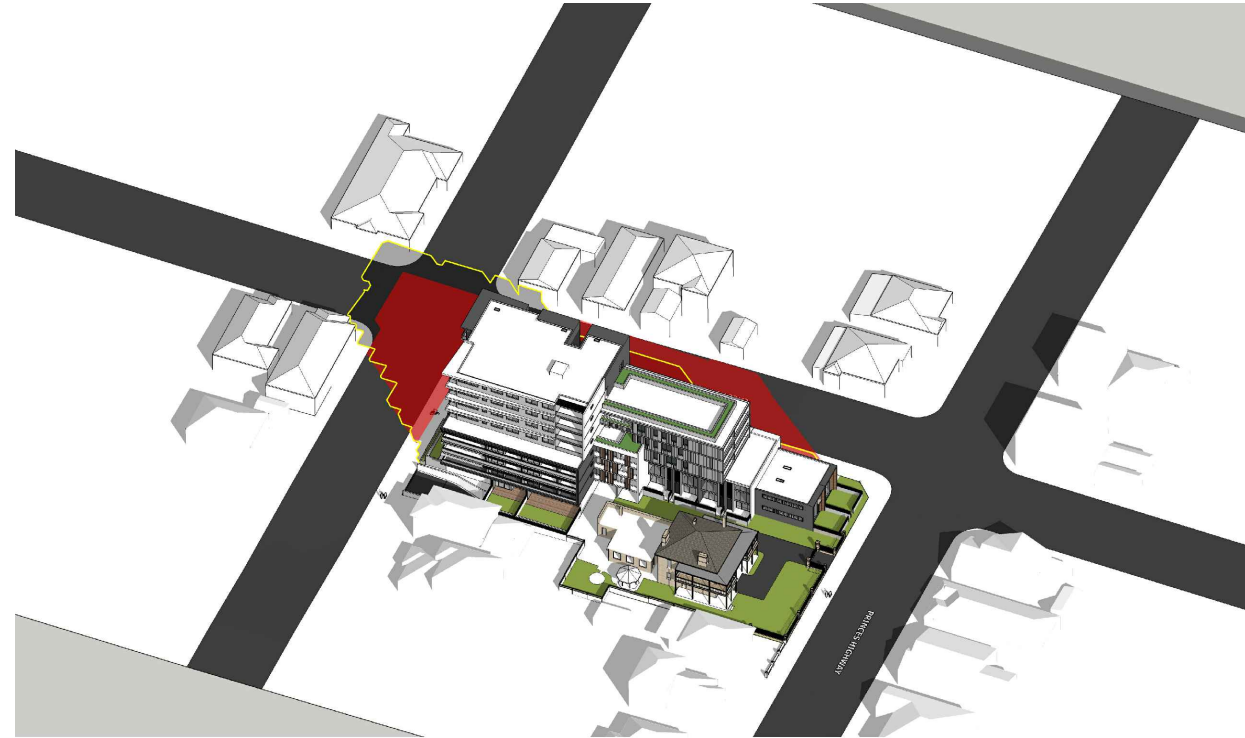

2 21ST DECEMBER - 12PM
NTS

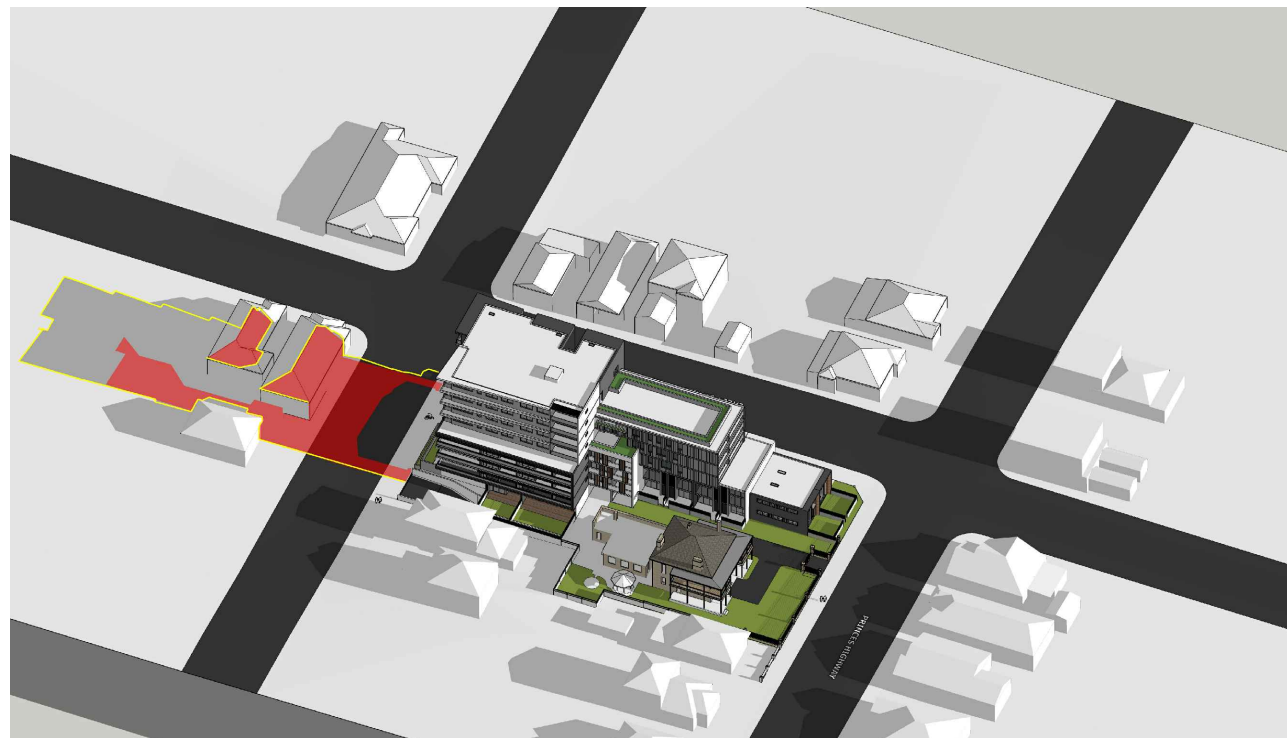

3 21ST DECEMBER - 3PM
NTS

LEGEND
 OUTLINE OF SHADOW CAST BY PROPOSED DEVELOPMENT
 SHADOW CAST BY COMPLIANT BUILD FORM
 SHADOW CAST BY EXISTING BUILDINGS

GENERAL NOTES:

- ALL WORKS TO COMPLY WITH BUILDING CODE OF AUSTRALIA, REQUIREMENTS OF RELEVANT STATUTORY AUTHORITIES/ LOCAL GOVERNMENT & RELEVANT AUSTRALIAN BUILDING STANDARDS
- CONTRACTOR TO VERIFY ALL DIMENSIONS ON SITE BEFORE COMMENCING WORK- SHOULD A DISCREPANCY BE IDENTIFIED PLEASE CONFIRM WITH ARCHITECT PRIOR TO PROCEEDING (DO NOT SCALE FROM DRAWINGS)
- DRAWINGS FOR THE PURPOSES OF DA ONLY - FURTHER CONSULTANT/ AUTHORITY COORDINATION WILL BE REQUIRED AT CC STAGE WHICH MAY IMPACT ON DESIGN AND PLANNING LAYOUTS
- COPYRIGHT OF DESIGN SHOWN HEREON IS RETAINED BY PBD ARCHITECTS AND AUTHORITY IS REQUIRED FOR ANY REPRODUCTION

LEGEND:

- FH FIRE HYDRANT
- FHR FIRE HOSE REEL
- FS FIRE STAIRS
- MV MECHANICAL RISER TO FUTURE DETAIL
- HW HIGHLIGHT WINDOW
- GC GARBAGE CHUTE
- LS LANDSCAPING (REFER TO LANDSCAPE ARCHITECT'S DRAWINGS)
- MB MAIL BOX TO FUTURE DETAIL
- WT HOT WATER UNITS
- CU A/C CONDENSER UNITS

MATERIALS LEGEND:

- AFG ALUMINIUM FRAMED GLAZING
- BS BATTEN SCREEN (TO FUTURE DETAIL)
- MP METAL PANEL (TO FUTURE DETAIL)
- MC METAL PANEL CLADDING (TO FUTURE SELECTION)
- PS PRIVACY SCREEN (TO FUTURE SELECTION)
- Px PAINT FINISH TYPEX
- TD TIMBER DOOR
- RD METAL ROLLER DOOR
- RW RENDERED WALL/SELECTED PAINT FINISH
- FB BRICKWORK
- RF ROOFING
- TF RECYCLED TIMBER FENCE

ISSUE	DATE	DESCRIPTION
A	2018.10.26	DA LODGEMENT

CLIENT:
TRULAND DEVELOPMENT PTY LTD

ARCHITECT:
PBD | ARCHITECTS
 ABN 36 147 035 550
 P - 02 9698 8140 E - info@pbdarchitects.com.au W - www.pbdarchitects.com.au
 Level 2, 52 Abillon Street, Sunny Hills NSW 2217

PROJECT:
PROPOSED HERITAGE CONSERVATION AND RESIDENTIAL FLAT BUILDING
 2-6 LACEY STREET KOGARAH BAY & 186-190 PRINCES HIGHWAY, BEVERLEY PARK NSW 2217

MARCH 2018
 DRAWING TITLE:
SHADOW IMPACT STUDY (PRE-DA)
 21st JUNE (9AM - 3PM)

SCALE: NTS	DRAWING NO: DA800	ISSUE: A
PROJECT NO: 1809		