

HIGHWAY

PRINCES

STREET

WYUNA

NOTES:

- 1) CAUTION: SHOULD ANY DEVELOPMENT OR CONSTRUCTION BE PLANNED ON OR NEAR THE BOUNDARIES, THE BOUNDARIES SHOULD BE CLEARLY MARKED ON SITE.
- 2) ALL AREAS AND DIMENSIONS HAVE BEEN COMPILED FROM PLANS MADE AVAILABLE AT LAND REGISTRY SERVICES.
- 3) ORIGIN OF LEVELS ON A.H.D. IS TAKEN FROM P.M. 53108 RL 21.294 A.H.D.
- 4) TREE SPREADS ARE DIAGRAMMATIC ONLY AND ARE NOT SYMMETRICAL.
- 5) UNDERGROUND (NON VISIBLE) SERVICE LINES HAVE BEEN SHOWN FROM "DIAL BEFORE YOU DIG" SERVICE AUTHORITY RECORDS & ARE DIAGRAMMATIC ONLY IN REGARD TO THEIR POSITION & WIDTH UNLESS STATED OTHERWISE.
- 6) SPOT LEVELS ARE ACCURATE.
- 7) BEARINGS SHOWN ARE ON M.G.A.-(MAP GRID OF AUSTRALIA).

INVESTIGATION OF "DIAL BEFORE YOU DIG" UNDERGROUND SERVICES HAS BEEN MADE. DETECTION OF UNDERGROUND SERVICES IS NOT AN INTEGRAL PART OF THIS SURVEY. ALL RELEVANT AUTHORITIES SHOULD BE NOTIFIED PRIOR TO ANY EXCAVATION ON OR NEAR THE SITE.

DEVELOPERS & EXCAVATORS MAY BE HELD FINANCIALLY RESPONSIBLE BY THE ASSET OWNER SHOULD THEY DAMAGE UNDERGROUND NETWORKS.

CARELESS DIGGING CAN:

- CAUSE DEATH OR SERIOUS INJURY TO WORKERS AND THE GENERAL PUBLIC
- INCORPORATE RISKS OF ELECTRICITY, GAS, WATER AND COMMUNICATIONS
- LEAD TO CRIMINAL PROSECUTION AND DAMAGES CLAIMS
- CAUSE EXPENSIVE FINANCIAL LOSSES TO BUSINESS
- CUT OFF EMERGENCY SERVICES
- DELAY PROJECT COMPLETION TIMES WHILE THE DAMAGE IS REPAIRED

MINIMISE YOUR RISK AND DIAL BEFORE YOU DIG.
TEL. 1100

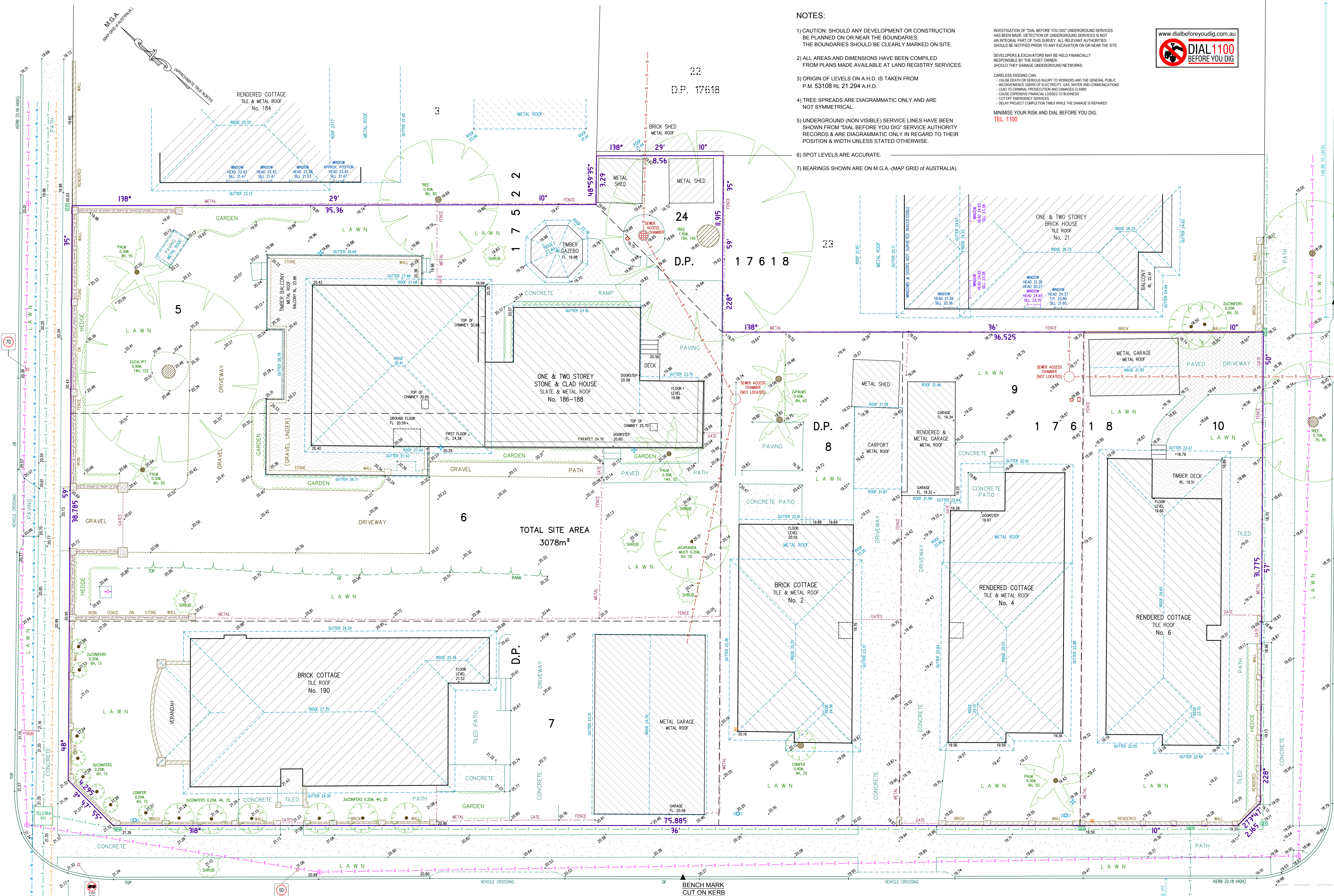

TOTAL SITE AREA 3078m²

BENCH MARK CUT ON KERB RL. 20.31 A.H.D

Bee & Lethbridge Pty Ltd
 Suite 2, 14 Starkey Street,
 PO Box 330, Forestville, NSW 2087
 Phone: 9451 6757 Fax: 9975 3535
 Email: survey@beelth.com.au
 ABN: 13 003 194 447
 www.beelth.com.au

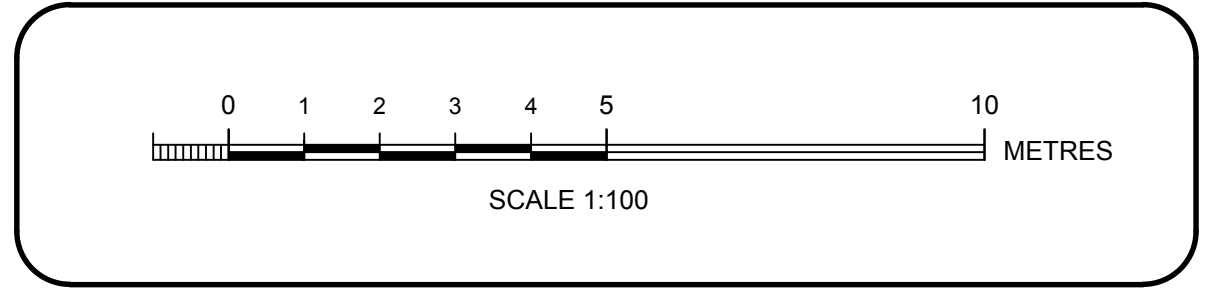

No.	DATE	SURVEYED	DRAWN	DESCRIPTION
02	11/07/2019	B.W.	R.M.	STORMWATER LINTELS ADDED IN WYUNA ST. & STUBBS ST.
01	16/01/2019	W.B.	R.M.	DRAINAGE PIT ADDED

LEGEND

- TREE 0.10m SH. 4.5 DENOTES APPROX. 0.10m DIAMETER OF TREE DENOTES APPROX. 5m HEIGHT OF TREE DENOTES APPROX. 4m SPREAD OF TREE
- GUTTER DENOTES CENTRE LINE OF ROAD DENOTES TOP OF GUTTER
- OVERHEAD ELECTRIC LINES
- BOARDS SEWER
- TELECOMMUNICATION LINES
- WATER LINES
- GAS LINES
- LIGHT POLE
- POWER POLE
- TELECOM. PIT
- SEWER VENT
- INSPECTION CAP
- STOP VALVE
- HYDRANT
- TAP
- WATER METER
- SIGN
- GAS METER

PLAN SHOWING BOUNDARIES, RELATIVE HEIGHTS & PHYSICAL FEATURES OVER LOTS 5-7 IN D.P. 17522, LOTS 8-10 & 24 IN D.P. 17618, KNOWN AS No. 186-190 PRINCES HIGHWAY, BEVERLEY PARK & No. 2-6 LACEY STREET, KOGARAH BAY.
 L.G.A.: GEORGES RIVER

CLIENT				REF No.			
TRULAND DEVELOPMENT				20870			
PROPERTY No. 186-190 PRINCES HIGHWAY, BEVERLEY PARK & No. 2-6 LACEY STREET, KOGARAH BAY							
DATUM	A.H.D.	SCALE	1:100 @ B1	DATE	20/02/2018	SHEET No.	1 of 1
SURVEYED	A.M.	DRAWN	R.M.	DWG No.	20870-02	REV No.	02